

## Automotive Relay Series 汽车继电器系列 -- JYKA

### FEATURES 特点

- 30A continuous current capability  
30A持续电流能力
- Singles and twin version available  
单、双电器可供选择
- Overall dimensions: single relay( 14.0X7.2X13.7 ) mm.  
double relay( 14.0X15.4X13.7 ) mm.  
外形尺寸: 单继电器 ( 14.0X7.2X13.7 ) mm  
双继电器 ( 14.0X15.4X13.7 ) mm

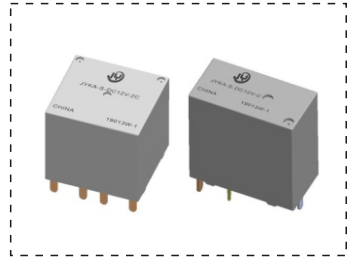

### CONTACT PARAMETERS 触点参数

Contact Form 触点形式	C-1组转换 2C-2组转换
Rating Load (Resistive) 额定负载	马达: 25A (冲击) 14VDC 阻性: 20A 14VDC
Max. Switching Current 最大切换电流	30A
Max. Switching Voltage 最大切换电压	16VDC
Max. Switching Power 最大切换功率	480W

### CHARACTERISTICS 性能参数

Contact Materials 触点材料	Ag Alloy	
Contact Resistance 接触电阻	100mΩ Max (6VDC 1A)	
Operate Time 吸合时间	10ms. Max	
Release Time 释放时间	10ms. Max	
Insulation Resistance 绝缘电阻	100MΩ Min. (DC500V)	
Initial Dielectric Strength 介质耐压	between open contacts: 触点与触点间:	AC 550 V, 50/60Hz 1Min
	between contacts and coil: 触点与线圈间:	AC 550 V, 50/60Hz 1Min
Vibration Resistance 抗振动	Damage limits: 耐久:	10~55Hz Double Amplitude 双振幅 3.3mm
	Malfunction: 误动作:	10~55Hz Double Amplitude 双振幅 3.3mm



Shock Resistance抗冲击	Damage limits: 耐久:	100G Min	
	Malfunction: 误动作:	10G Min	
Life寿命	Mechanical Life (10800 per hour) 机械寿命 (每小时10800次)	1 × 10 <sup>6</sup>	
	Electrical Life (1800 per hour) 电气寿命 (每小时1800次)	1 × 10 <sup>5</sup>	
Ambient Temperature环境温度	-40 °C ~ +105 °C (No condensation) (不冷凝)		
Unit Weight单位重量	约Approx4.0g (Singlet relay单继电器) 约Approx8.0g(Double relay单继电器)		

**COIL RATINGS (at23°C) 线圈参数 (在23°C)**

Coil Nominal Voltage 额定电压 (VDC)	Nominal Current 额定电流 ±10%(mA)	Coil Resistance 线圈电阻 ±10% (Ω)	Max. Continuous Voltage 最大连续外加电压	Pick-Up Voltage 吸合电压 (Max)	Drop-Out Voltage 释放电压 (Min)	Rated power 额定功率
6	110	56	Coil Nominal Voltage 130% 额定电压的130%	Coil Nominal Voltage 60% 额定电压的60%	Coil Nominal Voltage 10% 额定电压的10%	About 0.64 W 约0.64 W
9	70	127				
12	50	225				
24	30	900				
6	130	45	Coil Nominal Voltage 130% 额定电压的130%	Coil Nominal Voltage 60% 额定电压的60%	Coil Nominal Voltage 10% 额定电压的10%	About 0.8 W 约0.8 W
9	90	100				
12	70	180				
24	30	720				

**ORDERING INFORMATION订货标记**

JYKA-S-DC12V-A-D-T-(XXX) 1 2 3 4 5 6 7	
1. Model Number基本型号: JYKA 2. S-Plastic Sealed SH-Flux proofed S-塑封型 SH-防焊剂型 3. Coil Voltage线圈规格 (VDC): DC6V,DC9V,DC12V,DC24V 4. Contact form: C-1Form C 2C-2Form C 触点形式: C-1组转换 2C-2组转换	5. Coil Power:No-0.64 W, D-0.8W 线圈功率:无-0.64W, D-0.8W 6. Soldering:No-Standard,T-Reflow 焊锡方式:无-普通型, T-回流焊型 7. Customer Special Code :XXX-Customer Special Requirements No - Standard Type 客户特性号: XXX-客户特殊要求, 无-标准型

**OUTLINE DIMENSIONS (UNIT:mm)外形尺寸 (单位: mm)**

Single Relay  
单继电器

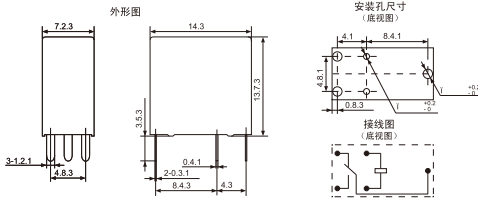

Double Relay  
双继电器

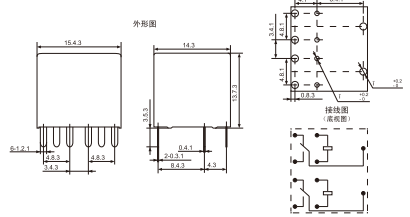

Single Relay (Reflow)  
单继电器 (回流焊型)

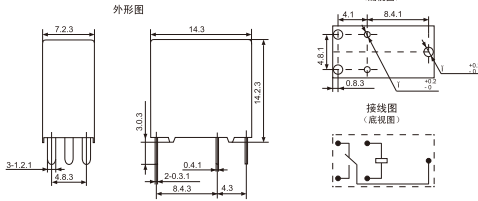

Double Relay (Reflow)  
双继电器 (回流焊型)

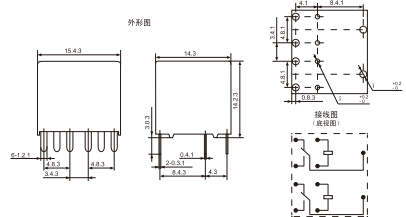

**PERFORMANCE CHART性能曲线图**

